

Be sure to read this instruction manual before using this product.
Keep this manual available for reference when needed.

Instruction for Use

Trade Name: Anesthesia screen with wing type

Contraindication/Prohibition

1. This product is only validated for use with Mizuho operating tables.
2. Ensure all clamp handles are tight. Failure to do so may result in a patient injury.
3. Do not cover the patient's face with a screen.
[Remove the screen immediately, when it covers the patient's face]

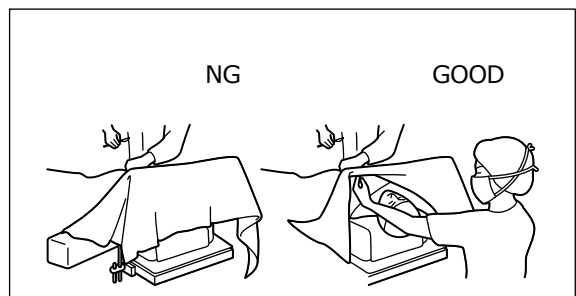

Shape/ Structure

1. Shape/Structure

Standard Type

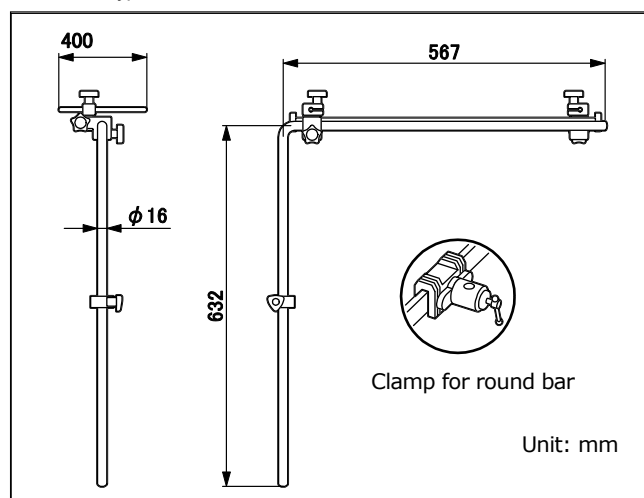

| Code No. | Product Description |
|-----------|---|
| 08-061-20 | Anesthesia screen with wing type with clamp |
| 08-110-01 | Clamp for round bar |

UE Type

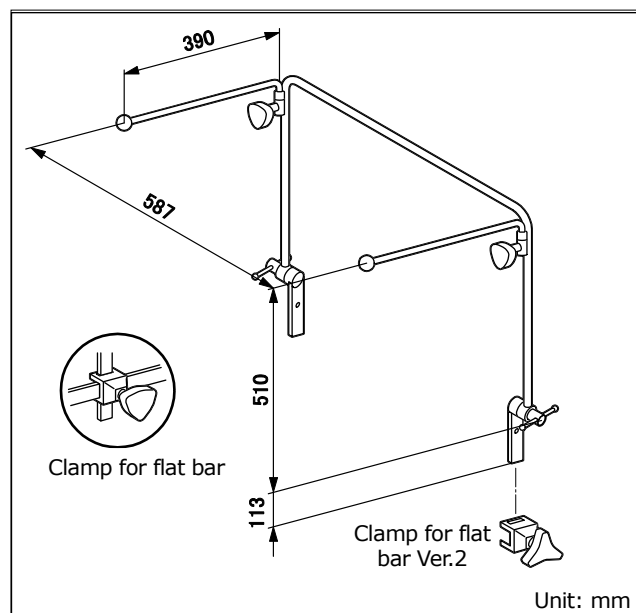

| Code No. | Product Description |
|--------------|---|
| 08-061-20-UE | Anesthesia screen with wing type (UE)*1 |
| 08-117-02 | Clamp for flat bar (R1)*2 |
| 08-117-10 | Clamp for flat bar Ver.2 (R1)*3 |
| 08-117-12 | Clamp for flat bar (R2)*4 |
| 08-117-13 | Clamp for flat bar Ver.2 (R2)*5 |

Mizuho provides two clamp styles appropriate for use with 08-061-20-UE (*1). Please select *2, *3, *4 or *5 to use *1.
(*2 *3: for U.S., *4 *5: for Europe)

2. Weight

- Main body : 2.0kg (08-061-20), 2.8kg (08-061-20-UE)
- Clamp for round bar: 0.9kg
- Clamp for flat bar (R1/R2): 0.5kg
- Clamp for flat bar Ver.2 (R1/R2): 0.4kg

3. Material

- Main body : Stainless steel rod, Synthetic resin.
- Clamp for round bar:
 - Stainless cast steel
- Clamp for flat bar (R1/R2):
 - Stainless steel / Plastic molding
- Clamp for flat bar Ver.2 (R1/R2):
 - Stainless steel / Aluminum alloy

Intended purpose

This is an accessory to an operating table. This is an anesthetic screen frame with adjustable wings. This frame is to be attached to an angle-adjustable clamp mounted on one of the side rails of an operating table.

Instructions for use

Standard Type

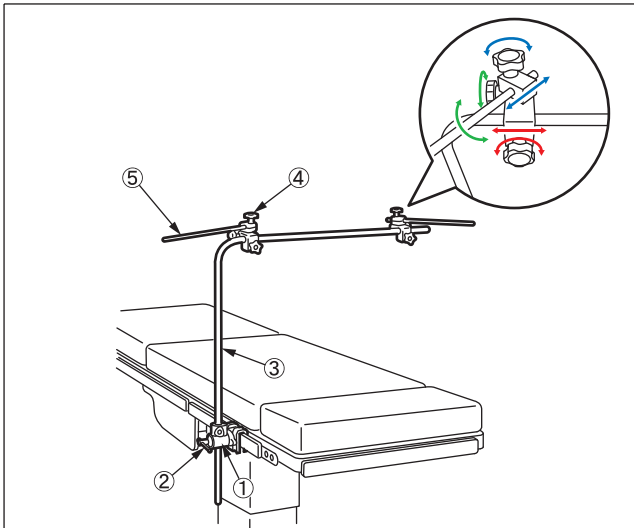

1. Attach the clamp for round bar① to the side rail of an operating table.
2. Insert the anesthesia screen frame③ into the rail clamp① and tighten the clamping handle② to temporarily secure the frame.
3. Move the anesthesia screen frame③ to a position appropriate for the patient's posture.
4. After the adjustment, tighten the clamping handle② to secure the clamp① and the anesthesia screen frame③.
5. Adjust the position of the wing⑤ at the clamping handle④ as needed.

UE Type

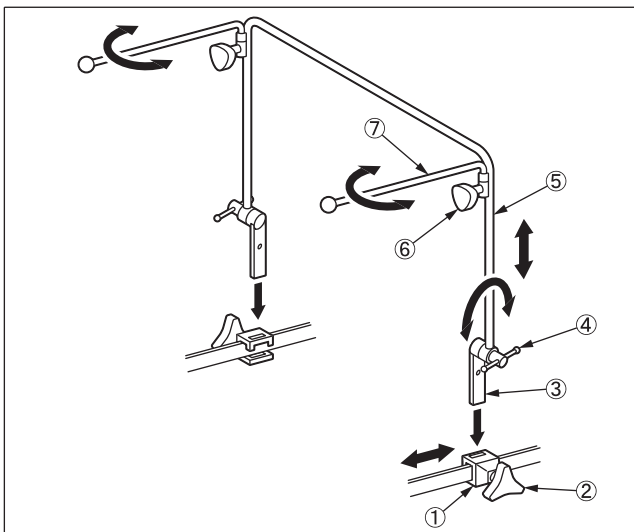

1. Attach the clamp for round bar① to the side rail of an operating table.
2. Insert the anesthesia screen frame⑤ into the rail clamp① and tighten the clamping handle② to temporarily secure the frame.
3. Move the anesthesia screen frame⑤ to a position appropriate for the patient's posture.
4. After the adjustment, tighten the clamping handle④ to secure the anesthesia screen frame⑤.
5. Adjust the position of the wing⑦ at the clamping handle⑥ as needed.

Caution

When working with an operating table, take care not to allow this product to make contact or interfere with the table top or with other tools and appliances used in combination with this product.

Storage/Life

1. Do not store the device in high temperatures or in areas with high humidity where the temperature has drastic variations.
2. Service life of this product: 7 years
(subject to the specified maintenance and inspection and is stored properly)

Maintenance/Inspection

<By the user>

1. Check before and after use
Check that this product is not damaged or broken before and after use.
2. Cleaning and disinfection
Wipe off blood, chemicals, contaminants, and other stains with water, and clean the device with gauze or other material moistened with alcohol to disinfect.
3. In case of malfunction
If you need to have this product repaired, clearly label the device as "Broken", "Need repair" etc. and contact your local dealer or Mizuho.

<By suppliers>

Maintenance and inspection can only be carried out certified suppliers of Mizuho.

Packing

1 piece per pack

Matters related to warranty period

MIZUHO Corporation will repair defective parts of this product without charge for one year from the date of delivery/installment except for cases of damage caused by a third party's repair, act of nature, improper use or damage on purpose. All other warranty terms and conditions are subject to regulations of MIZUHO Corporation

* Name and address of manufacturer



MIZUHO Corporation
3-30-13 Hongo, Bunkyo-ku, Tokyo 113-0033, Japan
<http://www.mizuho.co.jp>

* Authorized Representative in Europe



Emergo Europe B.V.
Prinsessegracht 20, 2514 AP, The Hague
The Netherlands